



## Russell Lea, NSW

15 Edenhholme Road

4  
BED

2  
BATH

2  
CAR

PRB  
Real Estate



### Sunlit, spacious and flexible family living

A fantastic array of living spaces adds a wealth of appeal to this light and bright dual level brick residence, perfectly sized to meet the changing needs of a growing family. Featuring modern appointments throughout and a great flow to an ultra-private, child-friendly backyard, this ready-to-move-into retreat is perfectly placed, walking distance to local amenities, city transport and waterside parks.

- \* Generous lounge/living area plus open plan kitchen & dining
- \* Expansive upstairs family room opening out to a balcony
- \* Kitchen/dining leads out through glass double doors to yard
- \* Paved courtyard, deep level lawns ideal for kids and pets
- \* Kitchen with contemporary steel gas cooktop & dishwasher
- \* 4 bright upstairs bedrooms with built-ins and ceiling fans

### SOLD

**Contact:** Marcello Biviano  
0410 700 700

**Type:** House

**Sold Date:** 10/05/2014

**<http://www.prbrealestate.com.au>**

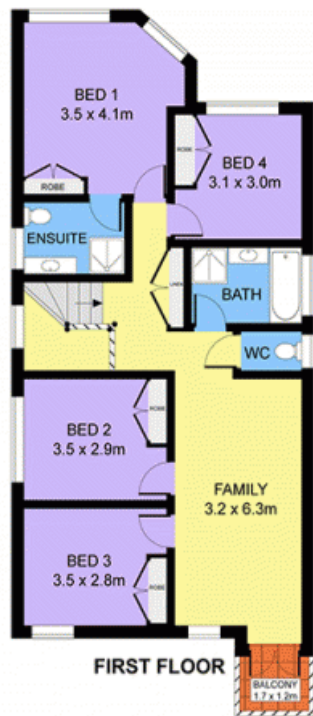

## 15 EDENHOLME ROAD, RUSSELL LEA

DISCLAIMER: PLANS SHOWN ARE FOR PRESENTATION PURPOSES AND ARE NOT PART OF ANY LEGAL DOCUMENT. ALL MEASUREMENTS AND FIGURES ARE APPROXIMATE.

Plans shown are only indicative of layout. Dimensions are approximate.

**Russell Lea, NSW**  
15 Edenholme Road