



## Five Dock, NSW

7 Kings Park Circuit

3  
BED

2  
BATH

2  
CAR

PRB  
Real Estate



### A peaceful retreat in a boutique two-level townhouse

This fresh and bright townhouse offers an easy living and convenient lifestyle opportunity in a well-maintained resort community. Quietly nestled at the end of a cul-de-sac, its well-planned two-level layout provides a great environment with well-presented interiors and plenty of potential for an update to introduce your own flair in the future. It's also ideally positioned within strolling distance to Five Dock's shopping, bus connections and local schools.

- \* A quiet parkside position with own private street entrance
- \* A generous layout features open lounge room and dining areas
- \* A spacious rear courtyard includes an undercover entertainment space
- \* Three upstairs bedrooms are all fitted with mirrored built-in wardrobes
- \* Private front balcony with leafy views over neighbouring Kings Park

### SOLD

**Contact:** Joe Rizzo  
0417 427 527  
Marcello Biviano  
0410 700 700

**Type:** Townhouse

**Sold Date:** 19/03/2021

**Land:** 236m<sup>2</sup>

<http://www.prbrealestate.com.au>



GROUND FLOOR

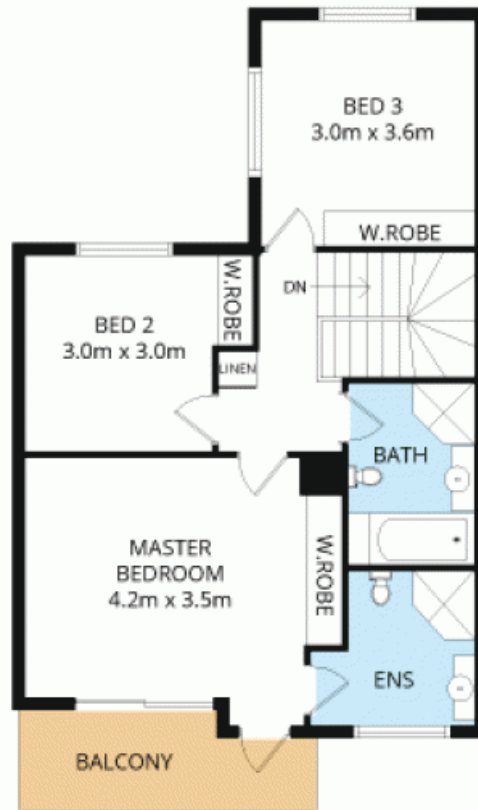
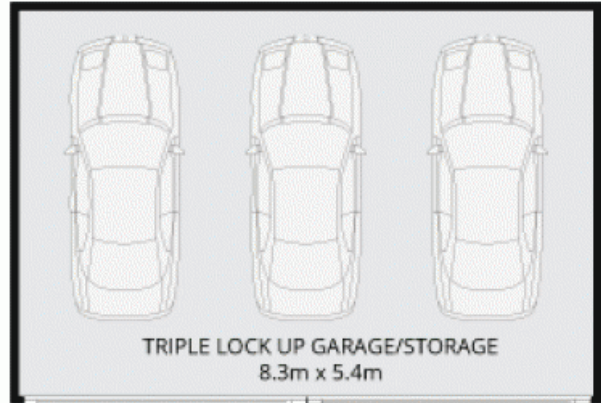

FIRST FLOOR



DISCLAIMER: THIS IS FOR ILLUSTRATIVE PURPOSES ONLY. ALL DIMENSIONS ARE APPROXIMATE AND IT DOES NOT CONSTITUTE PART OF ANY LEGAL DOCUMENTS.

ADDRESS:

**7 Kings Park Circuit, Five Dock**

Plans shown are only indicative of layout. Dimensions are approximate.

**Five Dock, NSW**  
7 Kings Park Circuit