



**Russell Lea, NSW**  
12 Liege Street

<b>4</b> BED	<b>3</b> BATH	<b>3</b> CAR	<b>PRB</b> Real Estate	
-----------------	------------------	-----------------	---------------------------	--

**North facing luxury family haven**  
Newly recreated from a traditional Californian bungalow into a luxuriously appointed contemporary retreat, this immaculate two storey family haven is designed for a lifestyle of relaxed indoor/outdoor entertaining. Set beneath soaring ceilings, drenched in sunlight and flowing out to level, north facing rear yard, the home is set in a central yet peaceful location, minutes walk to the waterfront, city buses and cafés.

**SOLD**  
**Contact:** Marcelllo Biviano  
0410 700 700  
Joe Rizzo  
0417 427 527  
**Type:** House  
**Sold Date:** 30/05/2013  
<http://www.prbrealestate.com.au>

- \* Stunning glass enclosed open plan lounge and dining
- \* Timber entertaining deck and child-friendly lawns
- \* Saltwater swimming pool framed by timber sundecks
- \* Gourmet CaesarStone kitchen with induction cooking
- \* Private master retreat with walk-in robe and ensuite
- \* Study/kid's retreat, guest w/c, timber floorboards



FIRST FLOOR



GROUND FLOOR

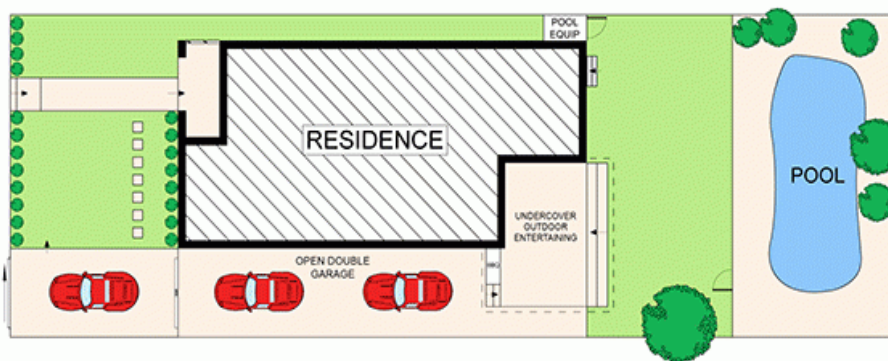

SITE PLAN  
(NOT TO SCALE)



12 LIEGE STREET, RUSSELL LEA Floorplan by Only Real Estate Ph: 1300 760 390

DISCLAIMER: PLANS SHOWN ARE FOR PRESENTATION PURPOSES AND ARE NOT PART OF ANY LEGAL DOCUMENT. ALL MEASUREMENTS AND FIGURES ARE APPROXIMATE.

Plans shown are only indicative of layout. Dimensions are approximate.

**Russell Lea, NSW**  
12 Liege Street