



15 Edenhholme Road RUSSELL LEA NSW

4 2 2

A fantastic array of living spaces adds a wealth of appeal to this light and bright dual level brick residence, perfectly sized to meet the changing needs of a growing family. Featuring modern appointments throughout and a great flow to an ultra-private, child-friendly backyard, this ready-to-move-into retreat is perfectly placed, walking distance to local amenities, city transport and waterside parks.

- * Generous lounge/living area plus open plan kitchen & dining
- * Expansive upstairs family room opening out to a balcony
- * Kitchen/dining leads out through glass double doors to yard
- * Paved courtyard, deep level lawns ideal for kids and pets
- * Kitchen with contemporary steel gas cooktop & dishwasher

View : <https://www.prbrealestate.com.au/1508794>



Marcello Biviano
02 9712 3938

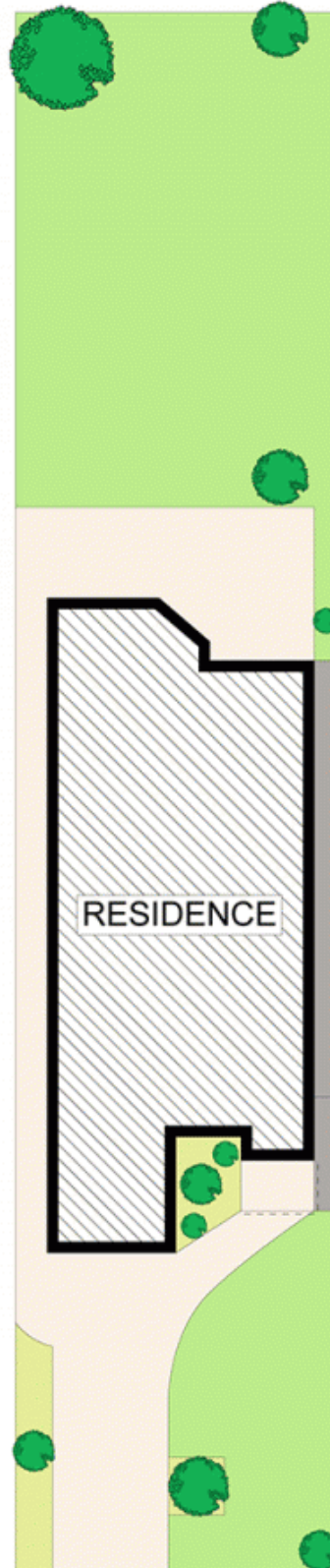
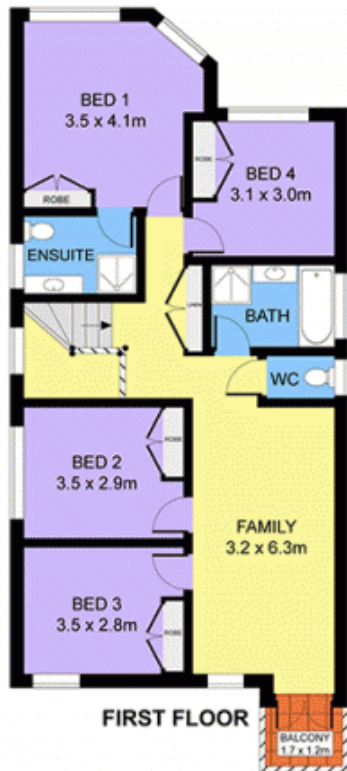

SITE PLAN
(NOT TO SCALE)



15 EDENHOLME ROAD, RUSSELL LEA

DISCLAIMER: PLANS SHOWN ARE FOR PRESENTATION PURPOSES AND ARE NOT PART OF ANY LEGAL DOCUMENT. ALL MEASUREMENTS AND FIGURES ARE APPROXIMATE.