

**12/6 Bortfield Drive CHISWICK NSW**

2 1 1

Prestigiously positioned at the tip of the peninsula, this spectacularly revamped apartment is literally seconds away from the water's edge and metres to Chiswick Ferry Wharf. Near-immaculate from a recent, high end renovation, its interiors are a showcase of sleek lines and elegant contemporary finishes.

Situated on the second floor of a sought-after security building, the apartment is directly opposite Armitage Reserve on Abbotsford Bay and is a short stroll to buses, local shops and cafes on Blackwall Point Road.

- \* Living/dining area flows to an oversized balcony
- \* CaesarStone kitchen w/ glass mosaic splashbacks
- \* High quality stainless steel oven and gas cooktop
- \* New built-in wardrobes in both the bedrooms
- \* Chic contemporary bathroom, internal laundry

**View :** <https://www.prbrealestate.com.au/1581436>



**Marcello Biviano**  
02 9712 3938



**Joe Rizzo**  
02 9712 3938

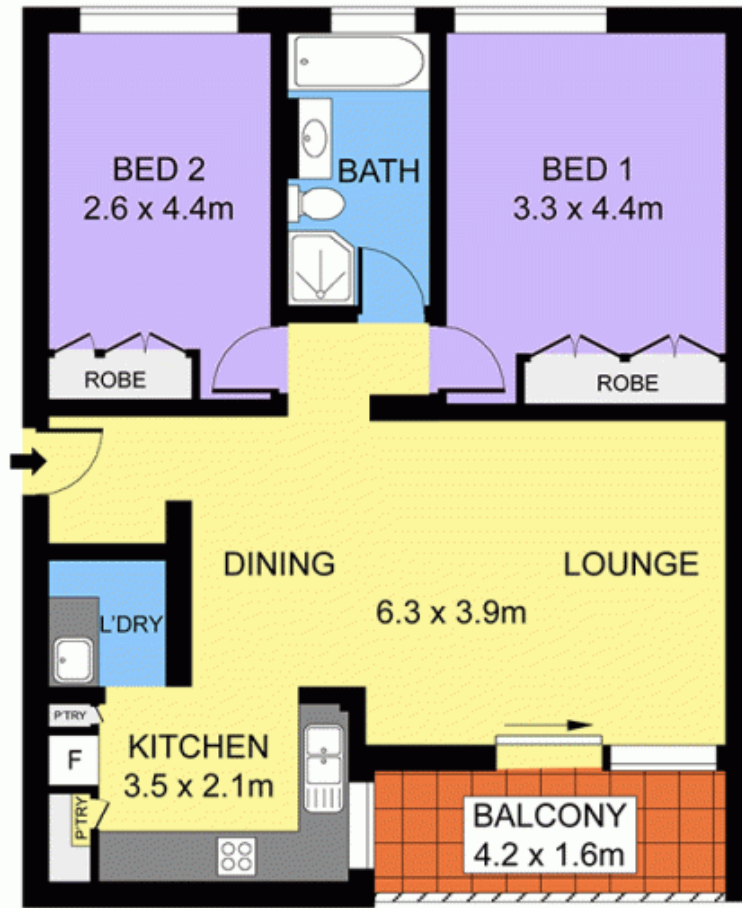

LEVEL 2

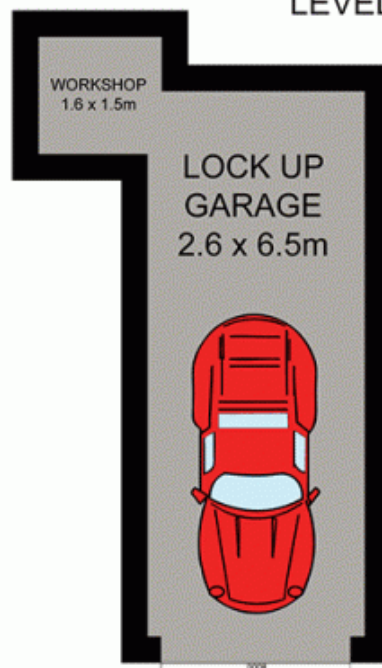

## 12/6 BORTFIELD DRIVE, CHISWICK

DISCLAIMER: PLANS SHOWN ARE FOR PRESENTATION PURPOSES AND ARE NOT PART OF ANY LEGAL DOCUMENT. ALL MEASUREMENTS AND FIGURES ARE APPROXIMATE.