



406/4-12 Garfield Street FIVE DOCK NSW

3 2 2

Architecturally arresting and visually exciting, this top floor apartment displays an exceptional dual level design capturing far reaching vistas from both front and back including the Harbour Bridge, CBD skyline, Hen and Chicken Bay and district. Featuring multiple balconies with a superb alfresco deck, a private master retreat, storage, secure parking and luxury finishes, it provides an exceptional lifestyle experience suited to busy executives, families or downsizers. Enjoying security entry and a lift, its perfect setting is just steps to the village hub with its popular shops and eateries, school and city bus.

Price : \$ 855,000

View : <https://www.prbrealestate.com.au/1657173>



Joe Rizzo
02 9712 3938



Marcello Biviano
02 9712 3938

- * North facing and streaming with natural light
- * Open plan living, dining and gourmet kitchen
- * Multiple balconies, outstanding alfresco deck
- * Two beds on lower level with adjoining balcony
- * Master retreat with his/hers robes and ensuite

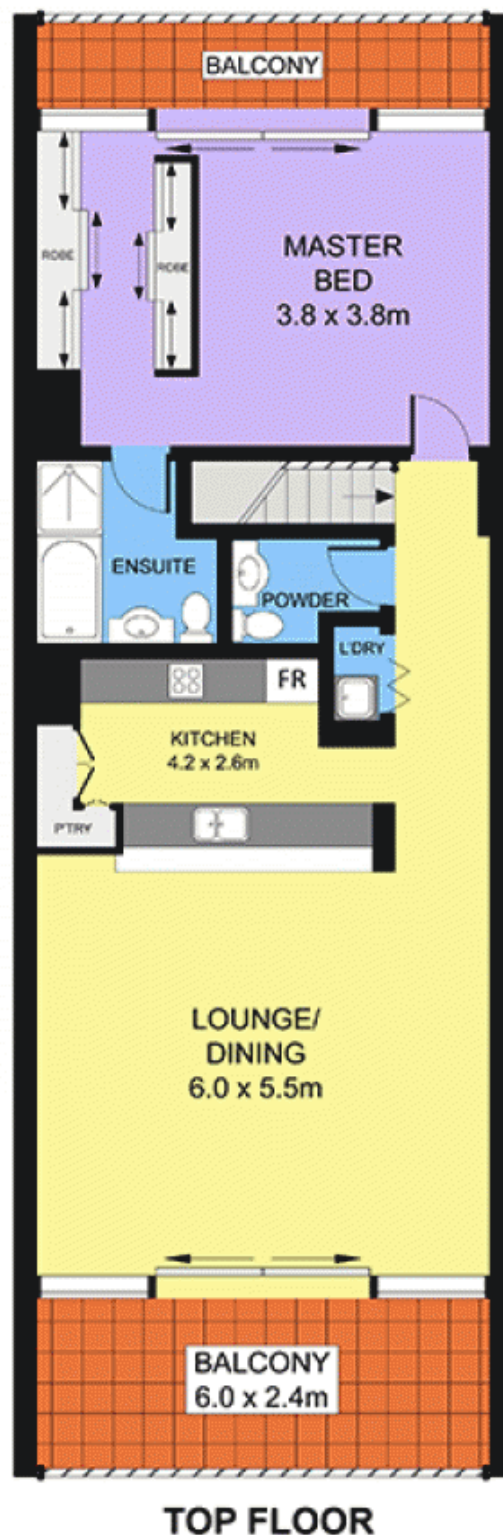
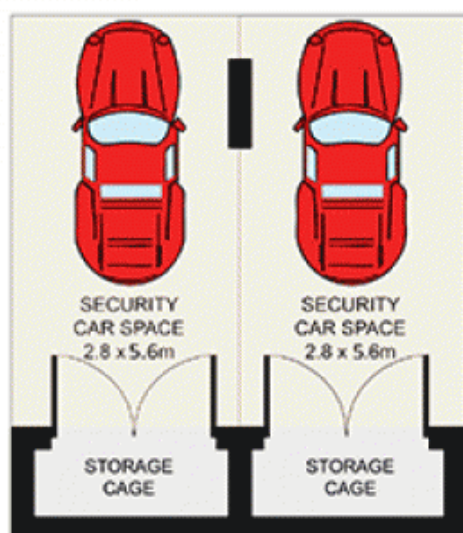
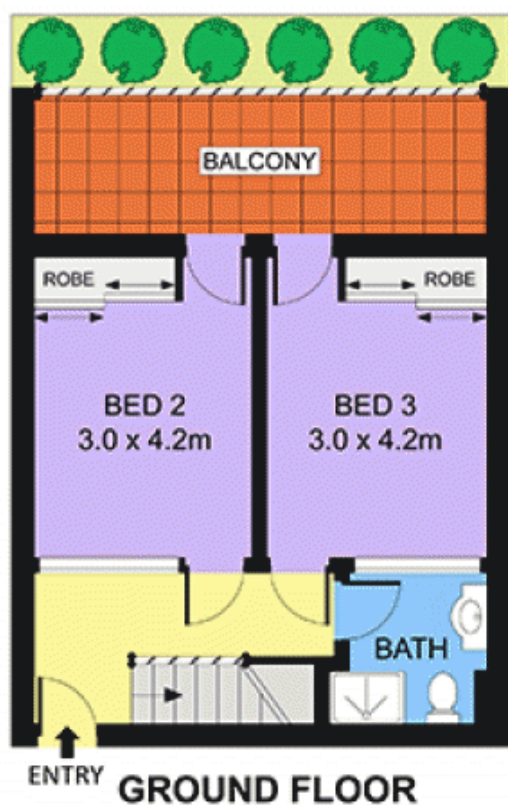

406/4-12 Garfield Street, Five Dock

DISCLAIMER: PLANS SHOWN ARE FOR PRESENTATION PURPOSES AND ARE NOT PART OF ANY LEGAL DOCUMENT. ALL MEASUREMENTS AND FIGURES ARE APPROXIMATE.