

## 28 Spring Street Abbotsford NSW

3 2 3

### Premier Peninsular Location

Set over a single level and perfectly suited to the young family or downsizer, this completely renovated home is the perfect introduction to one of the area's most convenient and highly sought after locations.

### Features Include:-

- \* Level paved alfresco courtyard, garden workshop/office
- \* 3 oversized bedrooms with built-in wardrobes
- \* Separate dining flowing on to a timber deck
- \* Updated kitchen with stainless steel gas appliances
- \* High end designer bathrooms
- \* Reverse cycle A/C ,state of the art security system
- \* Off street parking for 3 cars
- \* Freshly presented interiors and inviting modern details

**View :** <https://www.prbrealestate.com.au/3140874>



**Katie Gauntlett**  
**02 9712 3938**



GROUND FLOOR

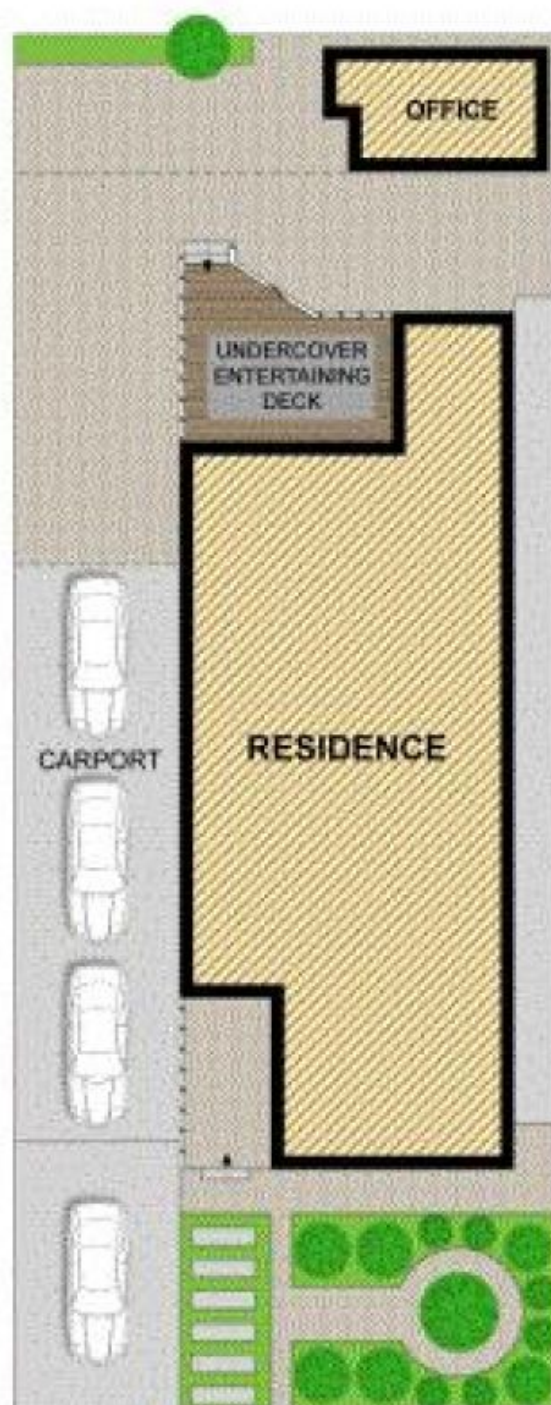

SITE PLAN (not to scale)