



30 Rowley Road RUSSELL LEA NSW

3 1 2

Immediately impressive thanks to its inviting traditional facade and extra-wide street frontage, this generous family residence effortlessly delivers a lifestyle of space, style and convenience. It has been tastefully updated throughout and designed to provide a great home for entertaining with a layout ideal for in/outdoor living. This popular family location bordering Drummoyne and Five Dock is in one of Russell Lea's best leafy streets and the property makes a great family home with future possibilities for development (STCA).

- * Set on a large 556sqm block with an extra-wide 15.24m frontage
- * Ideal north rear aspect with a pleasant outlook over the district
- * A great family layout with lounge, dining and living areas
- * Large covered deck that overlooks a deep rear garden

View : <https://www.prbrealestate.com.au/3441703>



Marcello Biviano
02 9712 3938



Joe Rizzo
02 9712 3938

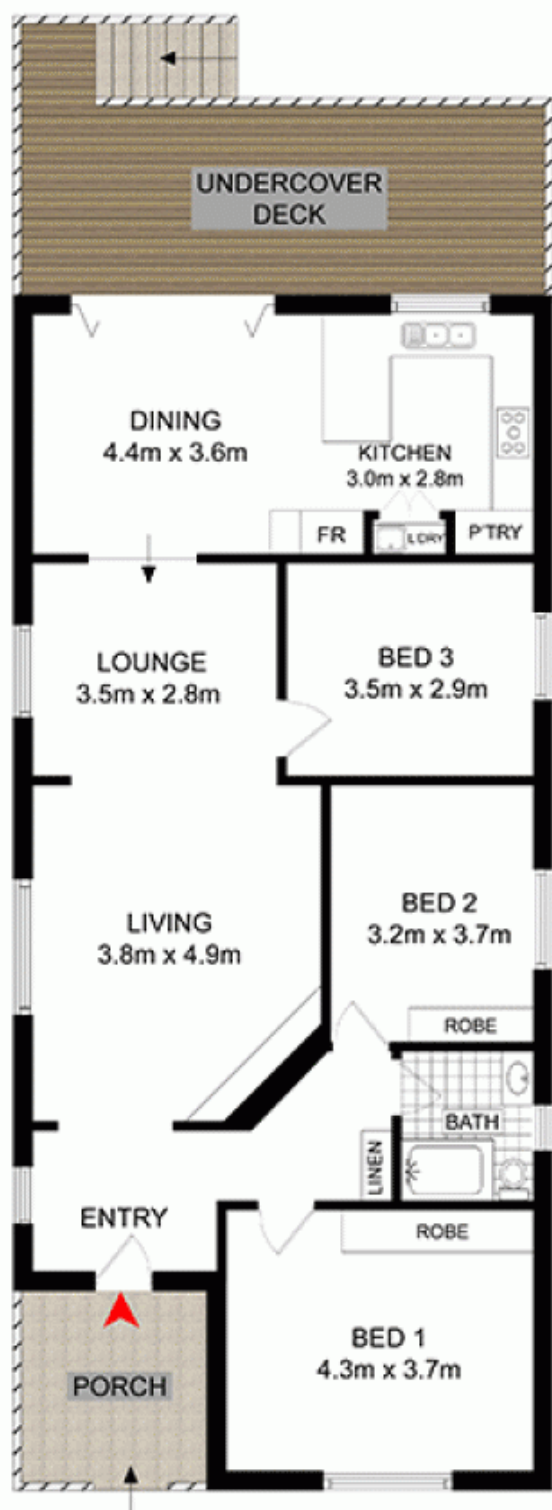

GROUND FLOOR



SITE PLAN (not to scale)

PRB
Real Estate



0 1m 2m 3m 4m



30 ROWLEY RD,
RUSSELL LEA

DISCLAIMER: PLANS SHOWN ARE FOR PRESENTATION PURPOSES AND ARE NOT PART OF ANY LEGAL DOCUMENT. ALL MEASUREMENTS AND FIGURES ARE APPROXIMATE.