



10/156 Hampden Road ABBOTSFORD NSW

2  **1**  **1** 

A fantastic home owner or investment package is on offer here with this large-sized two-bedroom apartment. Set at the rear of a small complex, it presents a great opportunity to own a fresh and easycare property that is quietly positioned while relishing close proximity to all of Wareemba's shops, cafes and dining options. There is also plenty of potential to further enhance to add some style and value if desired.

* Street level position with pleasant leafy outlooks, no stairs

* A generous layout with an open planned living and dining space

* Extra-wide balcony, lock-up garage and a huge storeroom on title

* Two large double-sized bedrooms one with built-in wardrobes

Price : \$ 810,000
Land Size : 120 sqm
View : <https://www.prbrealestate.com.au/6245041>



Joe Rizzo
02 9712 3938



Marcello Biviano
02 9712 3938

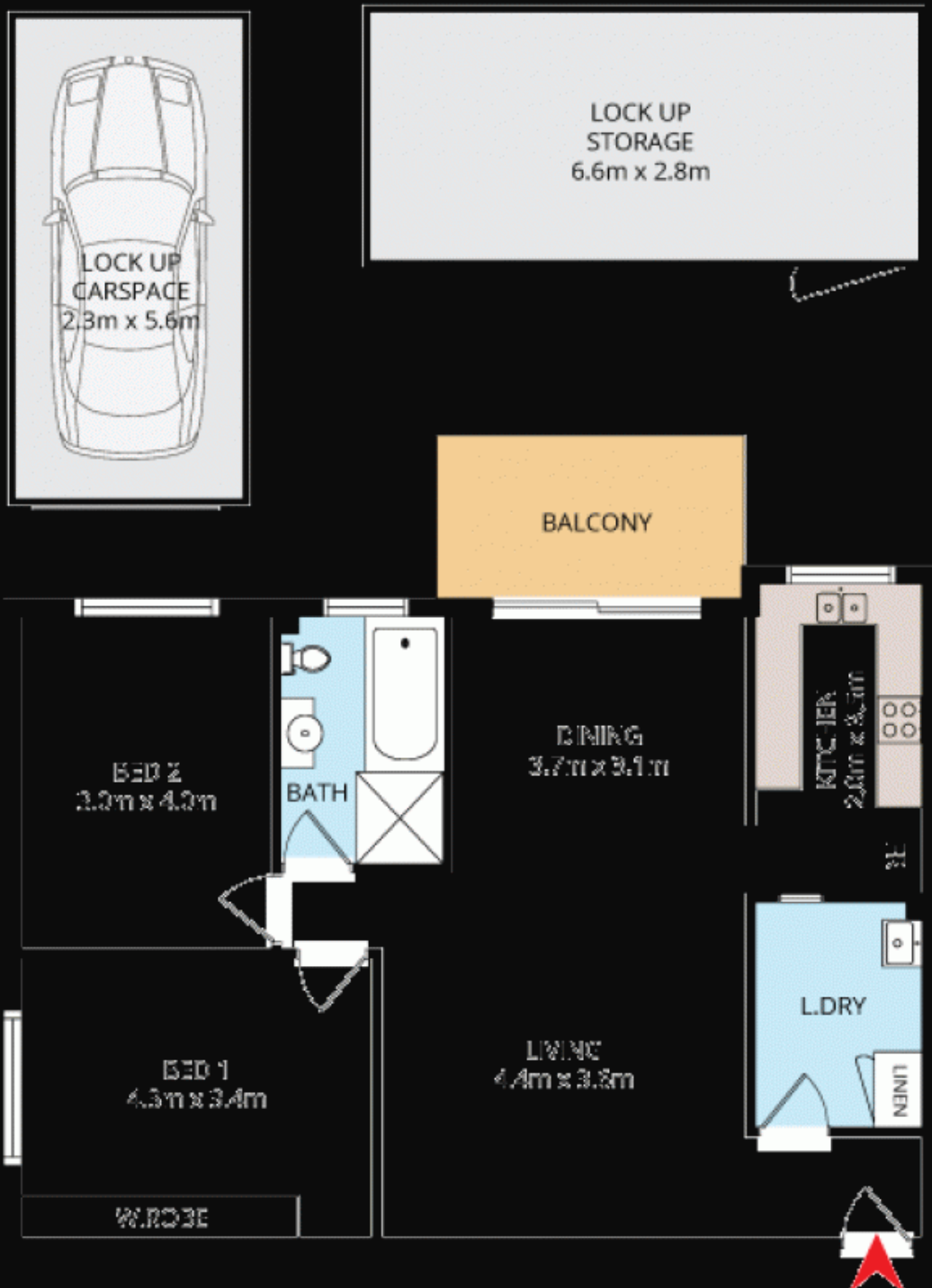

PRB
Real Estate



10158 HAMPDEN ROAD,
ABBOTSFORD

PRB REAL ESTATE HAS OBTAINED ALL INFORMATION IN THIS DOCUMENT FROM SOURCES BELIEVED TO BE RELIABLE. PRB REAL ESTATE, INC. CANNOT GUARANTEE ITS ACCURACY. PROSPECTIVE BUYERS ARE ADVISED TO CARRY OUT THEIR OWN INVESTIGATION.