



7 Kings Park Circuit FIVE DOCK NSW

3 2 2

This fresh and bright townhouse offers an easy living and convenient lifestyle opportunity in a well-maintained resort community. Quietly nestled at the end of a cul-de-sac, its well-planned two-level layout provides a great environment with well-presented interiors and plenty of potential for an update to introduce your own flair in the future. It's also ideally positioned within strolling distance to Five Dock's shopping, bus connections and local schools.

Land Size : 236 sqm
View : <https://www.prbrealestate.com.au/6329273>

- * A quiet parkside position with own private street entrance
- * A generous layout features open lounge room and dining areas
- * A spacious rear courtyard includes an undercover entertainment space
- * Three upstairs bedrooms are all fitted with mirrored built-in wardrobes



Joe Rizzo
 02 9712 3938



Marcello Biviano
 02 9712 3938



GROUND FLOOR

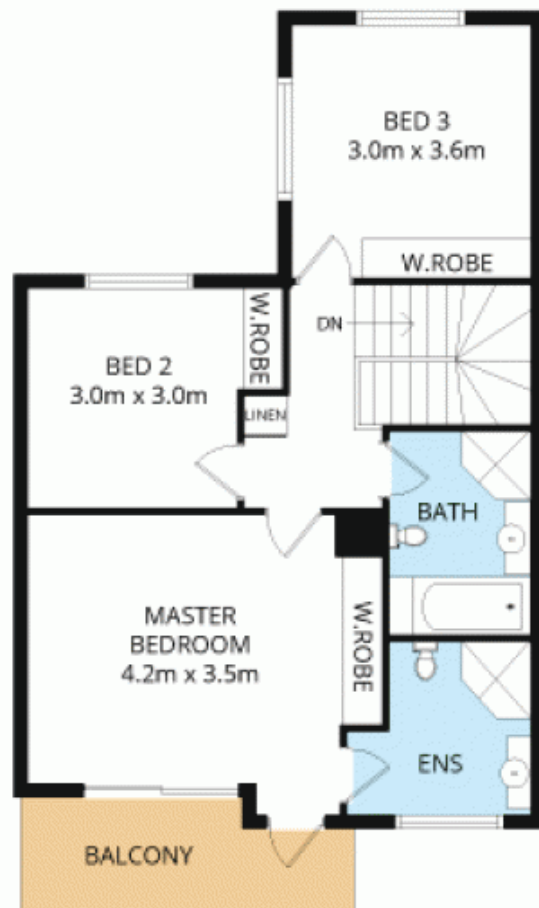
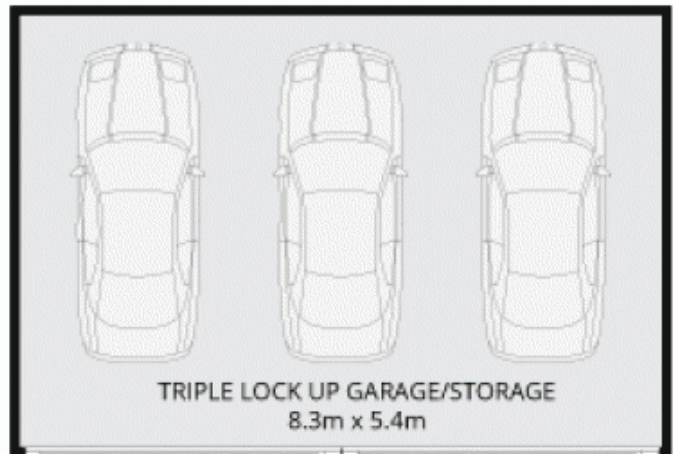

FIRST FLOOR



DISCLAIMER: THIS IS FOR ILLUSTRATIVE PURPOSES ONLY. ALL DIMENSIONS ARE APPROXIMATE AND IT DOES NOT CONSTITUTE PART OF ANY LEGAL DOCUMENTS.

ADDRESS:
7 Kings Park Circuit, Five Dock