



## 25 Fortescue Street CHISWICK NSW

4 3 4

Large families and upgraders will love the flowing sense of space and supremely functional floorplan of this impressively proportioned multi-level home. Well designed to provide a relaxed haven for the entertainer, it features a generous layout with excellent natural light and a focus on versatile living, along with its premium peninsula address that's footsteps to the water's edge. This superb property is ready for active households to move in and enjoy its wonderful location just a few minutes' stroll to Chiswick village shops, neighbourhood parks with bus and ferry transport to the city.

- \* Light and airy interiors feature a spacious open plan living area
- \* An easy flow to an outdoor dining patio and entertainment space
- \* Private grassed garden and a huge basement level

**Land Size** : 481 sqm  
**View** : <https://www.prbrealestate.com.au/7147938>



**Joe Rizzo**  
02 9712 3938



**Marcello Biviano**  
02 9712 3938

**SITE PLAN (not to scale)**

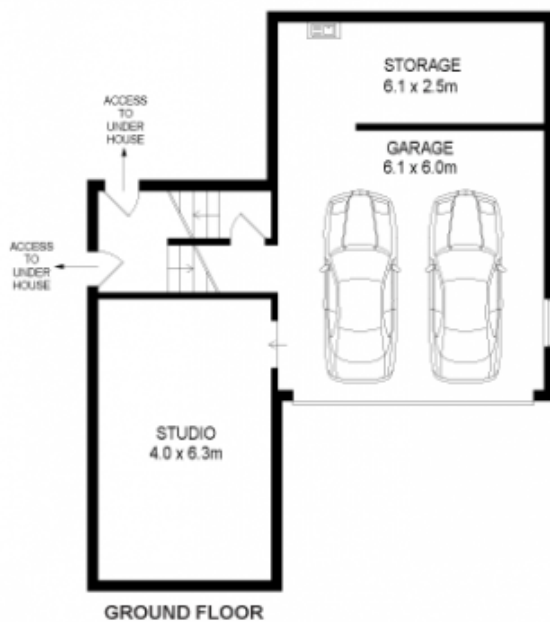

**25 FORTESCUE STREET,  
CHISWICK**

DISCLAIMER: WE HAVE OBTAINED ALL INFORMATION IN THIS DOCUMENT FROM SOURCES WE BELIEVE TO BE RELIABLE; HOWEVER, WE CANNOT GUARANTEE ITS ACCURACY. PROSPECTIVE PURCHASERS ARE ADVISED TO CARRY OUT THEIR OWN INVESTIGATIONS

**SITE PLAN (not to scale)**

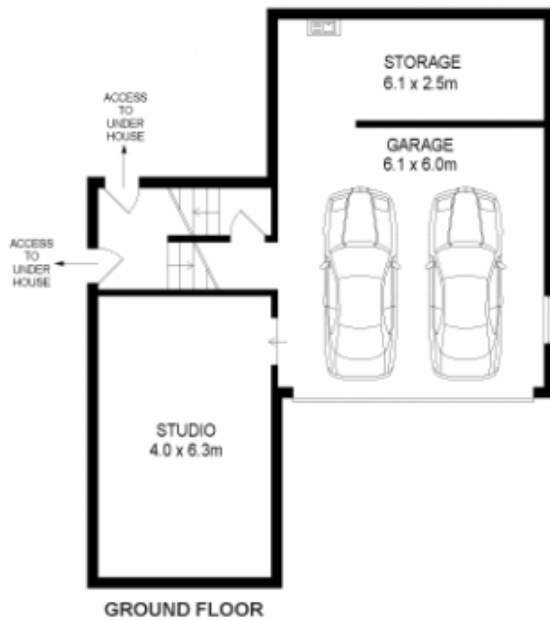

**25 FORTESCUE STREET,  
CHISWICK**

DISCLAIMER: WE HAVE OBTAINED ALL INFORMATION IN THIS DOCUMENT FROM SOURCES WE BELIEVE TO BE RELIABLE; HOWEVER, WE CANNOT GUARANTEE ITS ACCURACY. PROSPECTIVE PURCHASERS ARE ADVISED TO CARRY OUT THEIR OWN INVESTIGATIONS